

A Guide to Working with Cetopo's imported 3D model data

With Cetopo, all imported 3D data is seamlessly brought into Revit as native components of your choice, ready for immediate editing and integration within your design workflow.

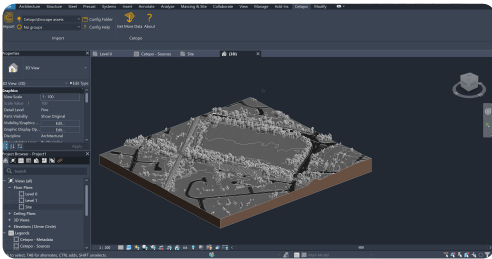

- **3D view:** Viewing and working with 3D data
- You can view **all 3D data** included in your import by navigating to the **default 3D view** by clicking on the 3D icon at the top of the interface. Make sure that massing is turned on through **'Visibility/Graphics'** to make your imported 3D buildings visible.

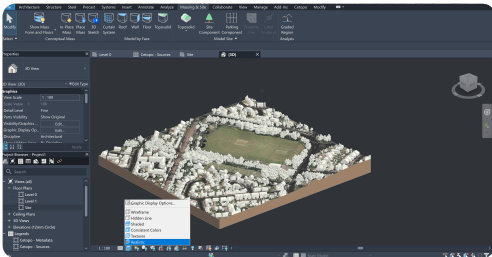

- **Visual Style:** Terrain finishes
- Change your **'Visual Style'** to **'Realistic with edges'** from the bottom of your interface to display the orthophoto or other terrain finishes.

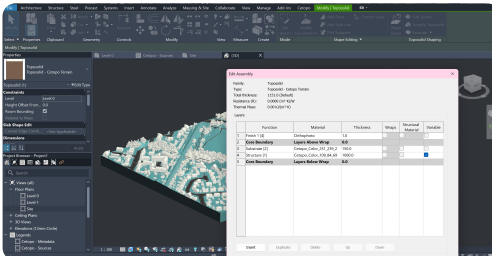

- **Data styles:** Native components
- Once the model has been imported, features included in your model will function identically to **natively modeled components**, making them easy to edit and work with.
- By configuring the component import options using the templates, **you have full control over how features are imported** - such as whether you would like terrain imported as detail lines or a toposolid.

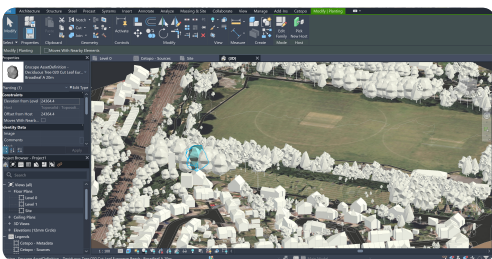

- **Tree configuration:** Trees as families
- Trees can be imported as masses or as families. Please see our tutorials on configuring tree imports to learn how to import trees as any planting families you wish.